



**INSTALLATION INSTRUCTIONS  
FOR 55-0023  
TRANSOM ADAPTOR.  
FOR MOTORS UP TO 20 HP  
Fits Panther Brackets  
55-0010, 55-0012, 55-0021,  
55-0022**

REV. 12/15

The TRANSOM ADAPTER allows the user to remove the outboard motor bracket along with outboard motor from transom of boat while not in use.

1. Mounting position of Transom Adapter must be exactly in the same position as described by manufacturer of the outboard motor bracket. For installation of bracket see Owner's Manual for 55-0010, 0012,0021,0022.
2. When position of the Transom Adaptor has been determined, drill (4) four 11/32" holes through transom, using the Transom Adaptor as template.
3. Place the Transom Adaptor over bolts (stainless steel) first, then through The Transom Adaptor. Locking device will be on left of adaptor facing transom.
4. Attach washers and nuts to supplied SS carriage bolts and tighten securely.
5. Slide the Outboard Motor Bracket down into the adaptor.
6. To theft-proof equipment, DROP-PIN, PADLOCK, CHAIN OR CABLE Locking devices can be used to secure the bracket to the adaptor through the locking hole.

Note: For existing installation, remove the outboard motor bracket from the transom of the boat, center the Transom Adaptor over the former Bracket position and proceed as described Under #2 above. REPAIR HOLES FORMERLY USED BY **BRACKET**.

**IMPORTANT: When trailering boat, remove motor from the Bracket.**

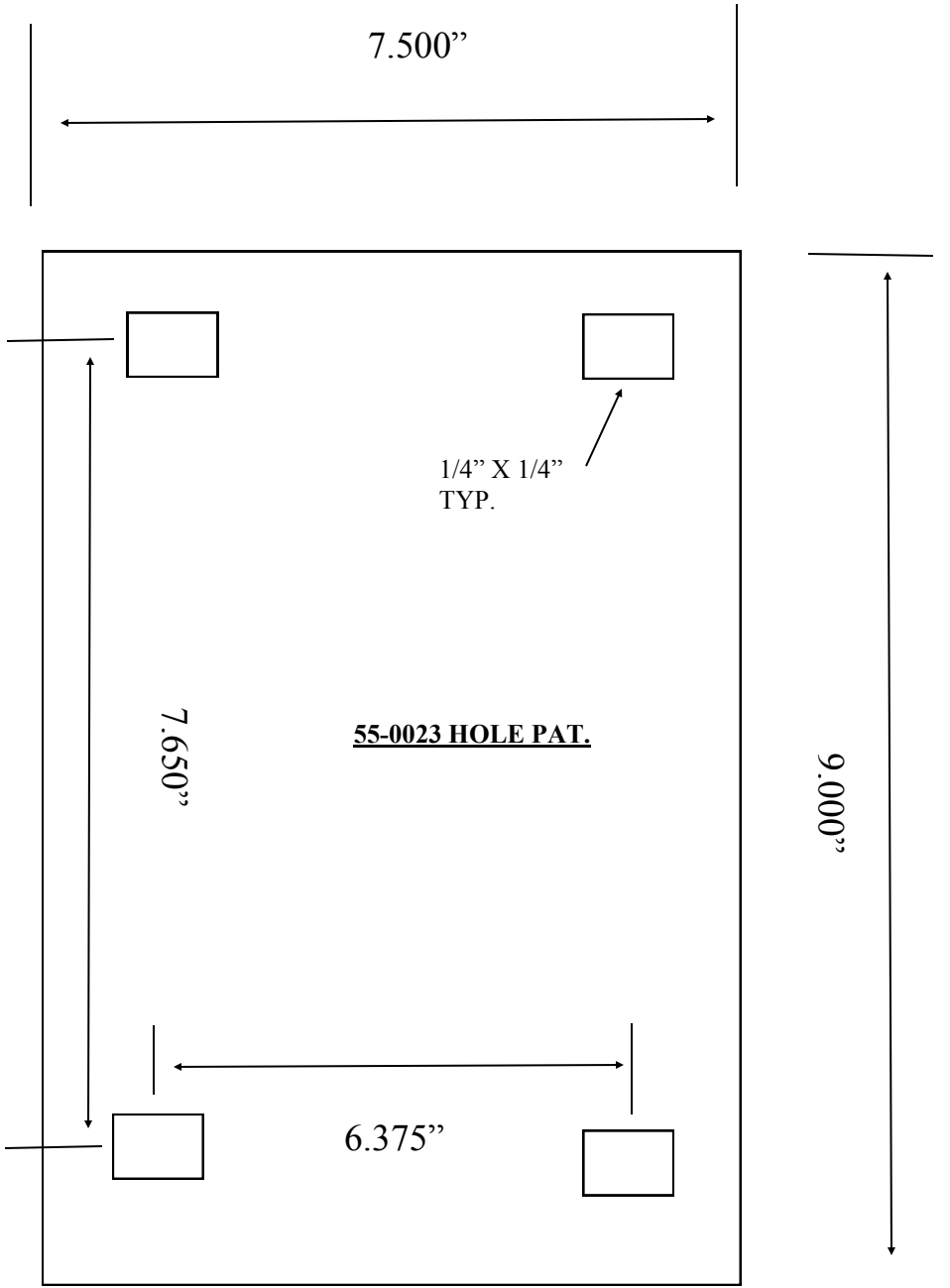

# SERVICE AND WARRANTY

Should your unit ever require service, *please do not return the product to your dealer*. Please call the number below for special instructions on shipping and handling. Please call between 9:00 am - 3:00 pm (Central Standard Time) Monday through Friday. If service is required and covered by warranty, it will be repaired or replaced as described below. If service is required and not covered by warranty, (such as damage caused from improper trailering or from water intrusion through the breather tube), replacement parts are available for purchase and may be paid for by Visa or MasterCard.

## The warranty coverage on this equipment is limited to the terms set forth below:

MarineTech Products, Inc. warrants this product to be free of defects in material and workmanship for a period of ONE (1) YEAR from the date of original retail purchase. **Positive proof of date of purchase is required for warranty service.** If service is required and covered by warranty, the unit will be repaired or replaced with new or factory rebuilt parts at no charge. The defective components must be returned to the address specified, with shipping charges prepaid. Be sure to include your name, address, telephone number and a copy of the sales receipt showing the date of original retail purchase. All sales receipts are subject to verification.

This warranty does not apply if the unit has been damaged by accident, abuse, misuse, poor installation or misapplication, or if it has been modified from its original condition, or if any serial number has been removed or defaced or altered. **This warranty does not cover any expense to remove or reinstall the unit or any of its components.** If a returned unit is not covered by warranty, the sender will be notified and given an estimate of the charges to repair or replace the unit, together with the return shipping charges.

THIS WARRANTY DOES NOT COVER SPECIAL, INCIDENTAL, OR CONSEQUENTIAL DAMAGES RESULTING FROM ANY BREACH OF WARRANTY, OR UNDER ANY OTHER LEGAL THEORY, INCLUDING BUT NOT LIMITED TO DAMAGE TO OR REPLACEMENT OF OTHER EQUIPMENT AND PROPERTY. THE WARRANTY AND REMEDIES SET FORTH ARE EXCLUSIVE AND IN LIEU OF ALL OTHERS, WHETHER ORAL OR WRITTEN, EXPRESS OR IMPLIED. DUE TO THE SPECIAL AND UNIQUE CONDITIONS THAT MAY EXIST IN EACH APPLICATION, THE MANUFACTURER SPECIFICALLY DISCLAIMS ANY AND ALL IMPLIED WARRANTIES OF MERCHANTABILITY AND FITNESS FOR A PARTICULAR PURPOSE. NO DEALER, AGENT OR EMPLOYEE IS AUTHORIZED TO MAKE ANY MODIFICATION, EXTENSION OR ADDITION TO THIS WARRANTY.

Some states do not allow exclusion of incidental or consequential damages, so the above exclusions may not apply to you. This warranty gives you specific legal rights, and you may also have other legal rights, which may vary from state to state.

**FOR SERVICE**  
**send an email to - [info@marinetechproducts.com](mailto:info@marinetechproducts.com)**

**or call 651.486.2010**

**MARINETECH PRODUCTS, INC**

1360 East County Road E  
VADNAIS HEIGHTS, MN 55110

[www.marinetechproducts.com](http://www.marinetechproducts.com)

*MarineTech Products, Inc. is proud to offer these fine lines.*



*SOLUTIONS FOR MOTOR MOUNTING, REMOTE STEERING, TILT & TRIM,  
SHALLOW WATER ANCHORS, AND SECURITY SYSTEMS*



*THE ORIGINAL ENGINE-MOUNTED ELECTRIC TROLLING  
MOTORS—HIGH THRUST WITH WHISPER QUIET EFFICIENCY*



*ROD HOLDERS, TROLLING MOTOR SUPPORTS, AND  
GPS/SONAR MOUNTS*



*AUXILIARY OUTBOARD MOTOR STEER SYSTEMS*



*THROTTLE CONTROL FOR GAS POWERED AUXILIARY MOTORS*

[www.marinetechproducts.com](http://www.marinetechproducts.com)